

Frame Ports and Connectors

Reference Formats

Input Formats	
480i	59.94Hz
576i	50Hz
720p	59.94Hz
720p	50Hz
1080i	59.94Hz
1080i	50Hz
1080pSF	23.98Hz
1080pSF	29.97Hz
1080pSF	25 Hz

Note: The number of inputs and outputs on your frame depends on the options ordered.

Note: Ethernet port 1 is the port located on the Switcher A module for both Switcher A and B.

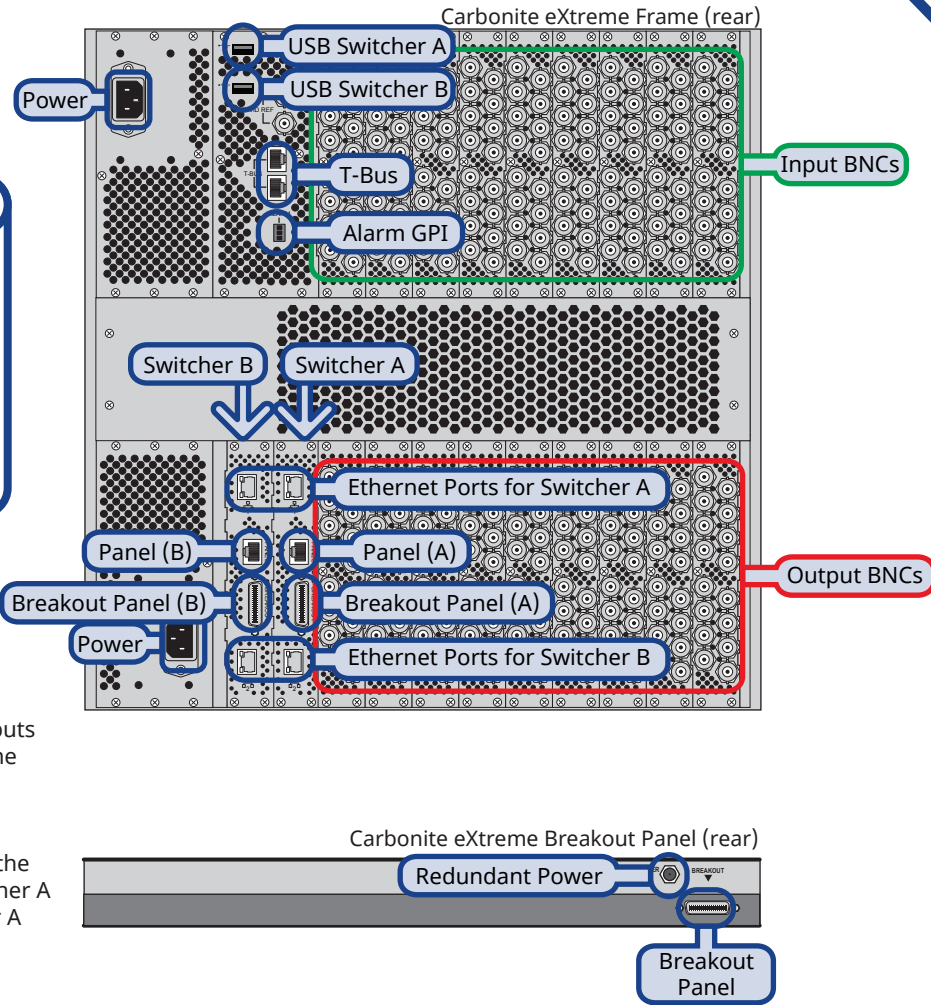

Breakout Panel Ports and Pinouts

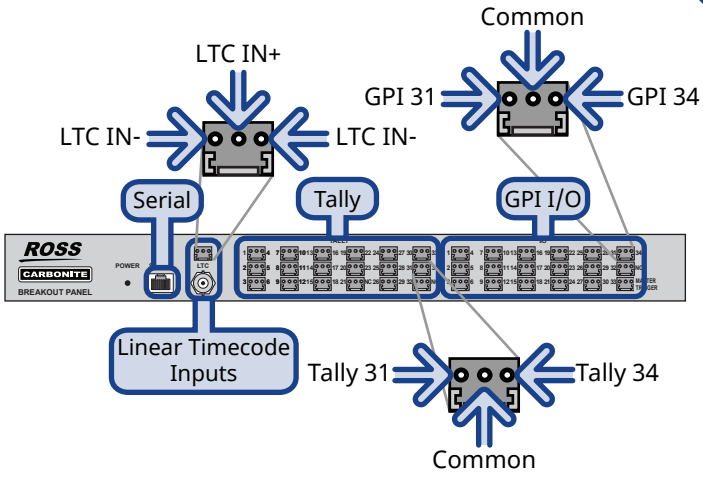

Serial (female RJ-45)

Pin	RS-422
1	Tx+
2	Tx-
3	Rx+
4	n/c
5	n/c
6	Rx-
7	Ground
8	Ground

Note: GPI Output Master Trigger is used as an emergency bypass for Master Control. If the switcher fails, this GPI output is triggered.

Power Switches and Frame Boards

Important: Only qualified service personnel are allowed to replace or service system boards and/or cards.

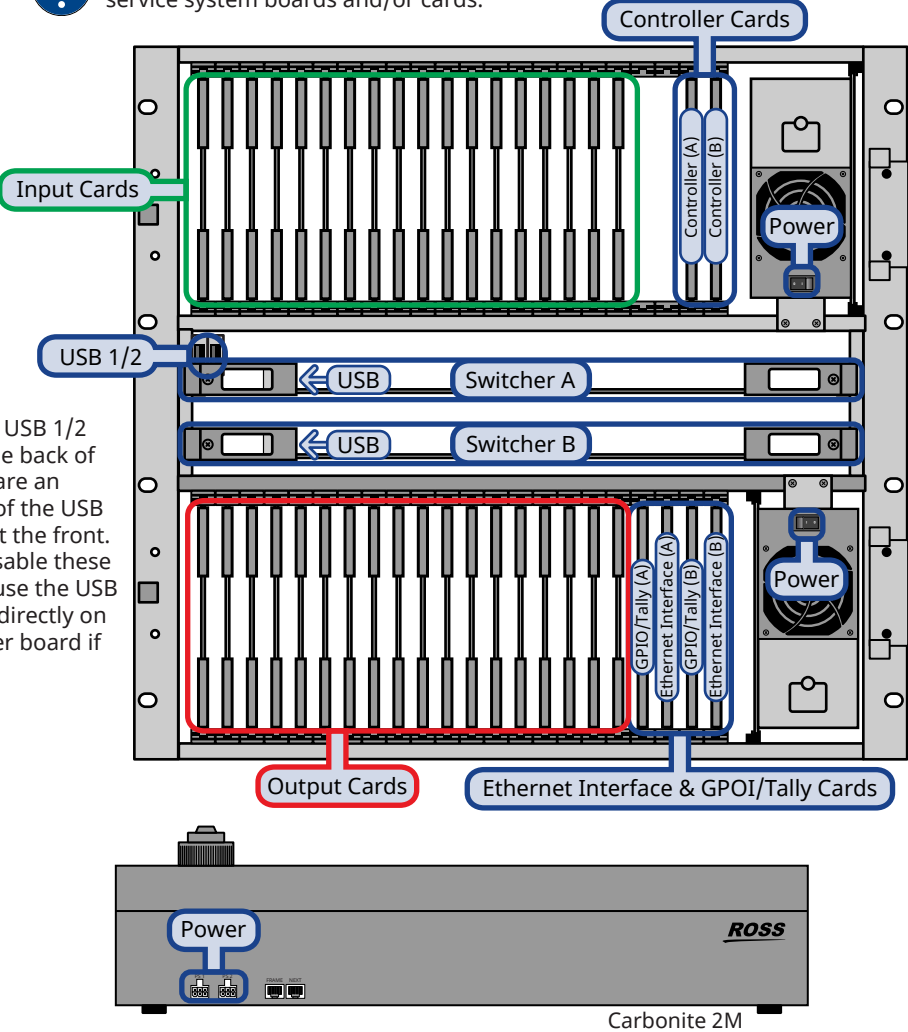

Note: The USB 1/2 ports on the back of the frame are an extension of the USB 1/2 ports at the front. You can disable these ports and use the USB connector directly on the switcher board if required.

Note: The C10 control panel has a power switch to power it on, or off. The other Carbonite control panels power on automatically when the power supply is plugged in.

Specifications

Default Values	
NK-IPS	192.168.20.100
Frame IP (LAN1)	192.168.0.123
Frame IP (LAN2)	0.0.0.0
FTP User name	user
FTP Password	password

Input Voltages	
Panel	100 - 120V~ 220 - 240V~ 47-63Hz
Frame	100 - 240V~ 50-60Hz 6.25 - 3.15A

Tally Rating	
Input Voltage:	24VAC (rms) / 40VDC
Maximum Current:	120mA
Impedance:	< 15 ohms
Temperature	
Operating:	0 - 40°C (32 - 104°F)
Storage:	-20 - 85°C (-4 - 185°F)

Power Consumption	
Carbonite 10	24W 2.0A 12V
Carbonite 1-A	30W 2.5A 12V
Carbonite 1M	30W 2.5A 12V
Carbonite 2	42W 3.5A 12V
Carbonite 2M	50W 4.2A 12V
Carbonite 2S	54W 4.5A 12V
Carbonite 2X	66W 5.5A 12V
Carbonite 3S	66W 5.5A 12V
Carbonite 3X	84W 7.0A 12V
eXtreme	500W 34A 14.6V

Video Input Specifications	
Equalization	>100m @ 1.5 Gb/s (using Belden 1694 cable)
Impedance	75 ohm, terminating
Video Inputs	SMPTE 259M/292M serial digital (non-looping)
Reference Inputs	Standard Definition — analog black (non-terminating, looping)High Definition — tri-level sync

Video Output Specifications	
Return Loss	< -23dB @ 1.5GHz < -18dB @ 3GHz
Rise and Fall Time	800ps +/- 10% (SD) 240ps +/- 10% (HD)
Signal Level	800mV +/- 10%
DC Offset	0 Volts
Overshoot	< 10%
HD Mode	10-bit SMPTE-292M serial digital

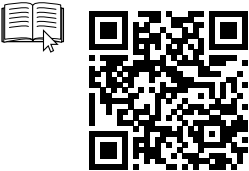

Power and Cabling

Note: Refer to the documentation that came with the Ross Routing Systems NK-IPS for setup information.

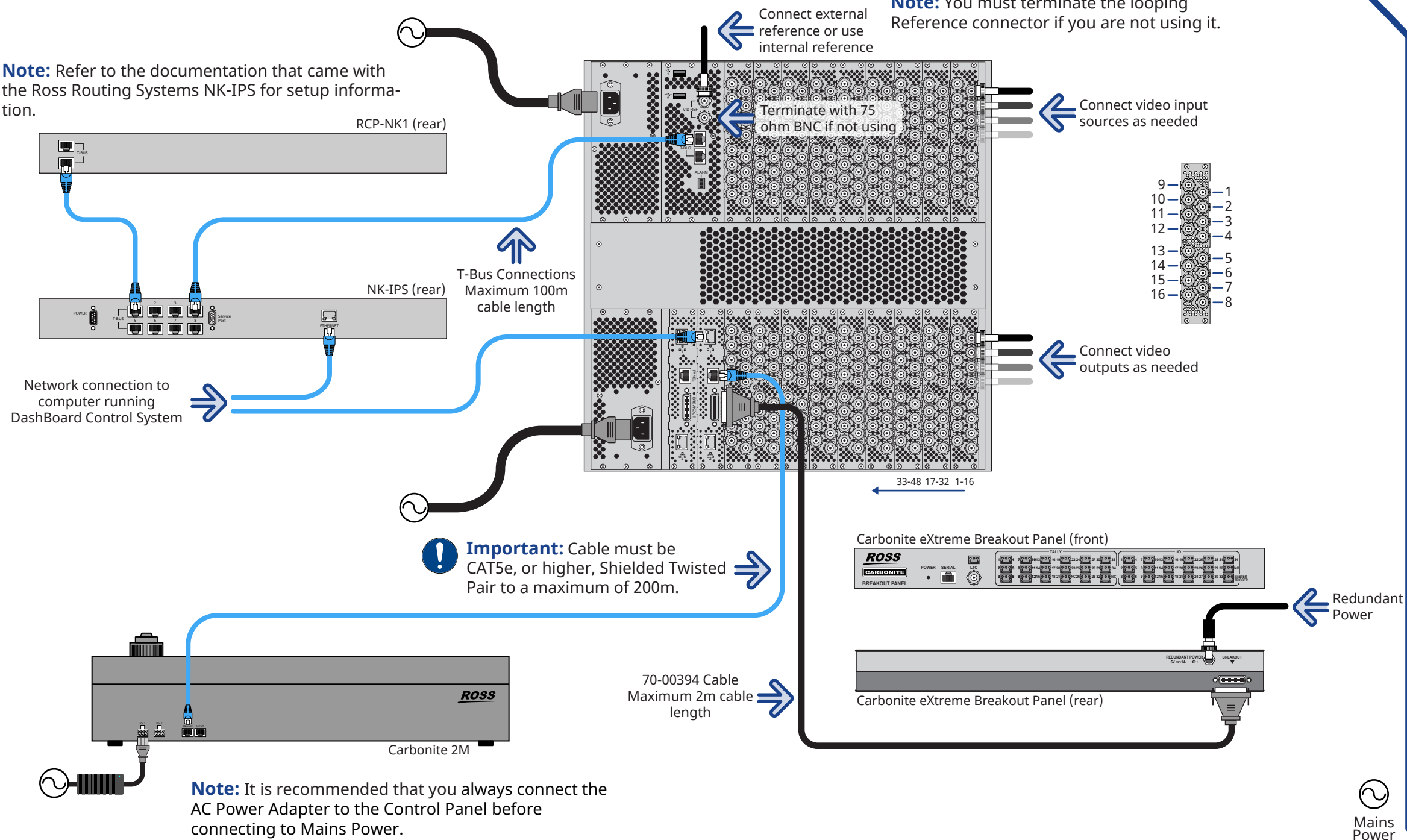

Frame Door Opening

Important: Only qualified service personnel are allowed to replace or service system boards and/or cards.

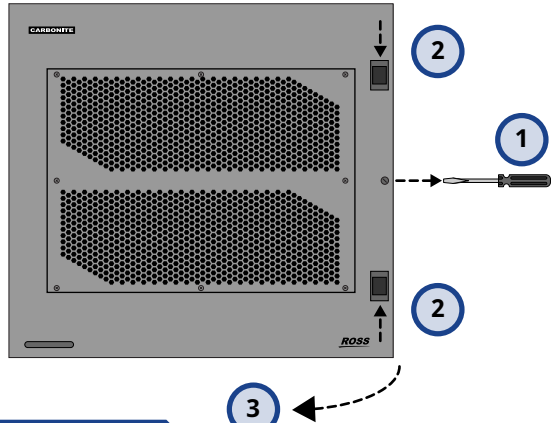

Frame Dust Filter

Remove frame door before cleaning the dust filter.

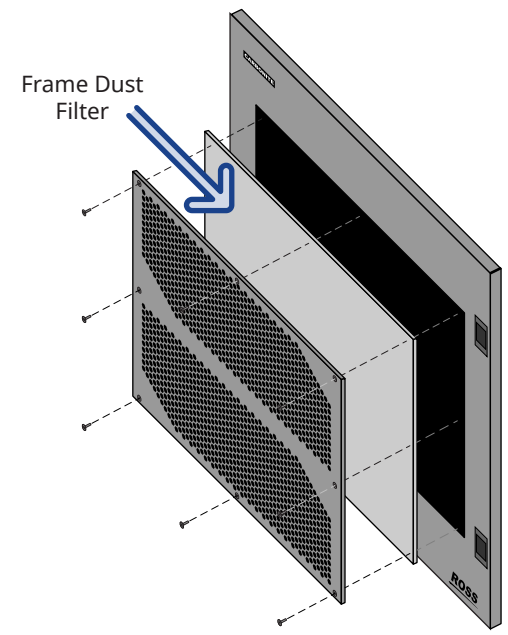

Note: The Dust Filter located inside the frame door should be kept clean and free of dust buildup to ensure proper cooling of the frame. Always ensure that the Dust Filter is covering all the holes in the door.



Having a problem? Call our free, 24-hour technical support hotline to speak with a live product specialist located right here in our facility.
Tel: (+1) 613 • 652 • 4886
Email: techsupport@rossvideo.com

